



70 NEWFOUNDLAND WAY

PORTISHEAD
BS20 7QE

70 NEWFOUNDLAND WAY

PORTISHEAD BS20 7QE







GOODMAN & LILLEY

01275 430440

lettings@goodmanlilley.co.uk

goodmanlilley.co.uk

@goodmanlilley

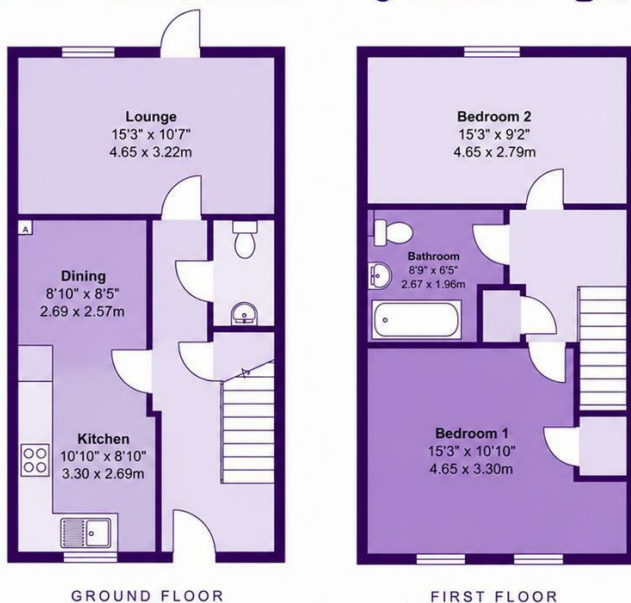

GROUND FLOOR

FIRST FLOOR

**Approximate Gross Internal Floor Area
840 sq ft / 78.0 sq m**

This plan is for layout guidance only. Not drawn to scale unless stated. Windows and door openings are approximate. Whilst every care is taken in the preparation of this plan, please check all dimensions, shapes and compass bearings before making any decisions reliant upon them.



GOODMAN & LILLEY

**GOODMAN & LILLEY
BRANCH NETWORK**

HENLEAZE

156 Henleaze Road
Henleaze
BS9 4NB
0117 213 0777
henleaze@goodmanlilley.co.uk

SHIREHAMPTON

9 HIGH STREET
SHIREHAMPTON
BS11 0DT
0117 213 0333
SHIRE@GOODMANLILLEY.CO.UK

PORTISHEAD

Rembrandt House
36 High Street
Portishead
BS20 6EN
01275 430440
sales@goodmanlilley.co.uk

LETTINGS

01275 299010
LETTINGS@GOODMANLILLEY.CO.UK

CLEVEDON

28 Hill Road
Clevedon
BS21 7PH
01275 403 660
clevedon@goodmanlilley.co.uk

LAND & NEW HOMES

0117 213 0151
LNH@GOODMANLILLEY.CO.UK

2 BEDROOMS
TENURE -

1 RECEPTION ROOMS
IN ALL 840.00 SQ FT

1 BATHROOMS
COUNCIL TAX BAND - C

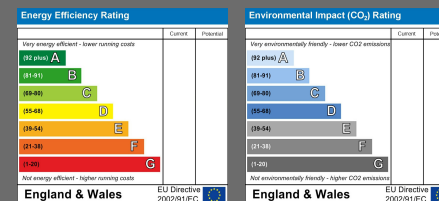

Opening hours vary slightly in each office
Mon to Fri - Usually 9am till 6pm
Saturday 9.00am-4.00pm